

Inteleviewer Installation Guide

1. Download the appropriate Inteleviewer installation track (32-bit, 64-bit or MAC) from the Spectrum Medical Imaging Website.
2. Read the License Agreement, then tick the box accepting the terms. Click 'next'

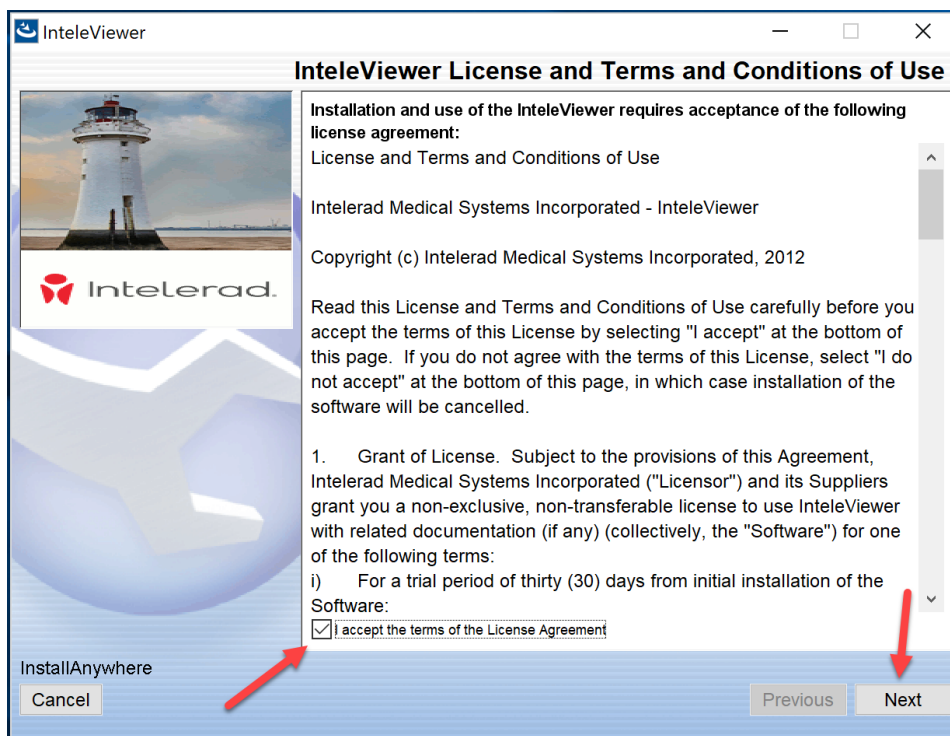

3. Read the Oracle Binary Code license agreement and accept the terms. Click 'next'

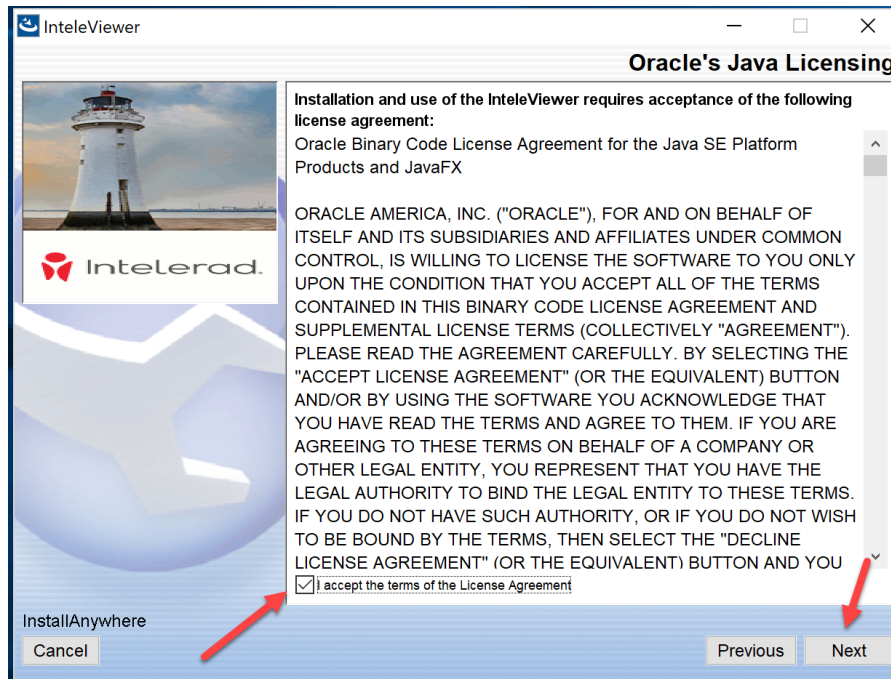

4. Select the destination for your installation folder on your computer. Click 'next'

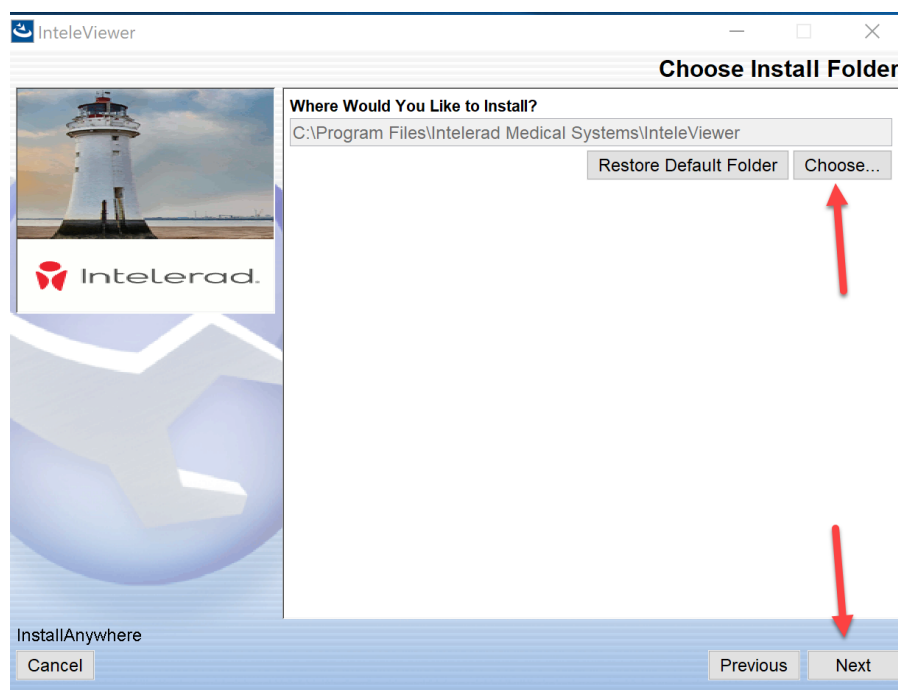

5. Select 'All Users'. Click 'next'

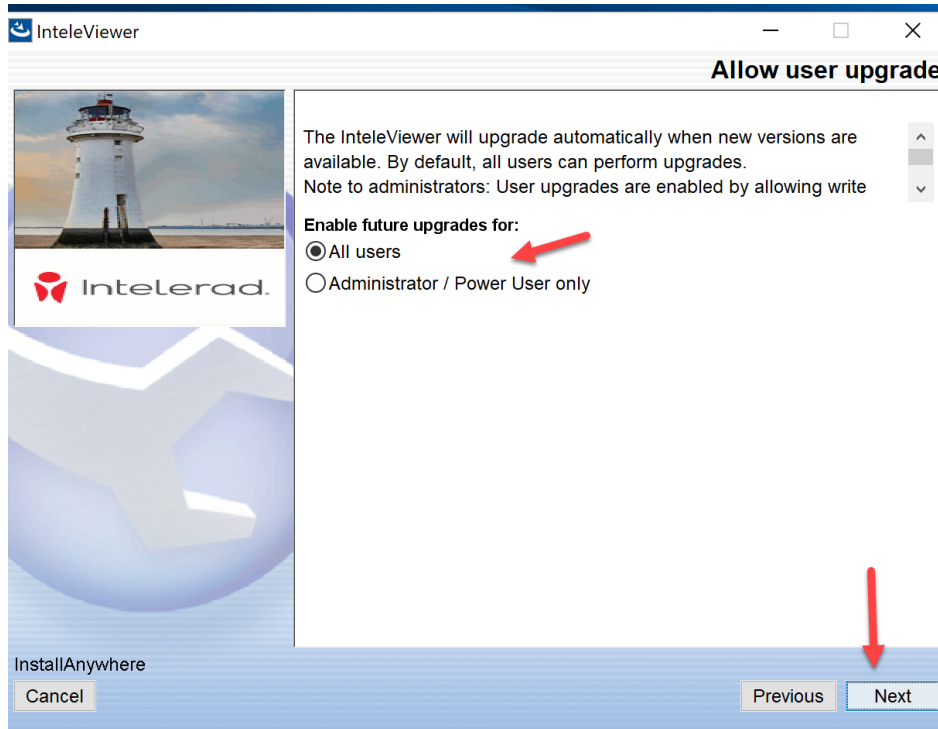

6. Select 'Disable DICOM Service'. Click 'next'

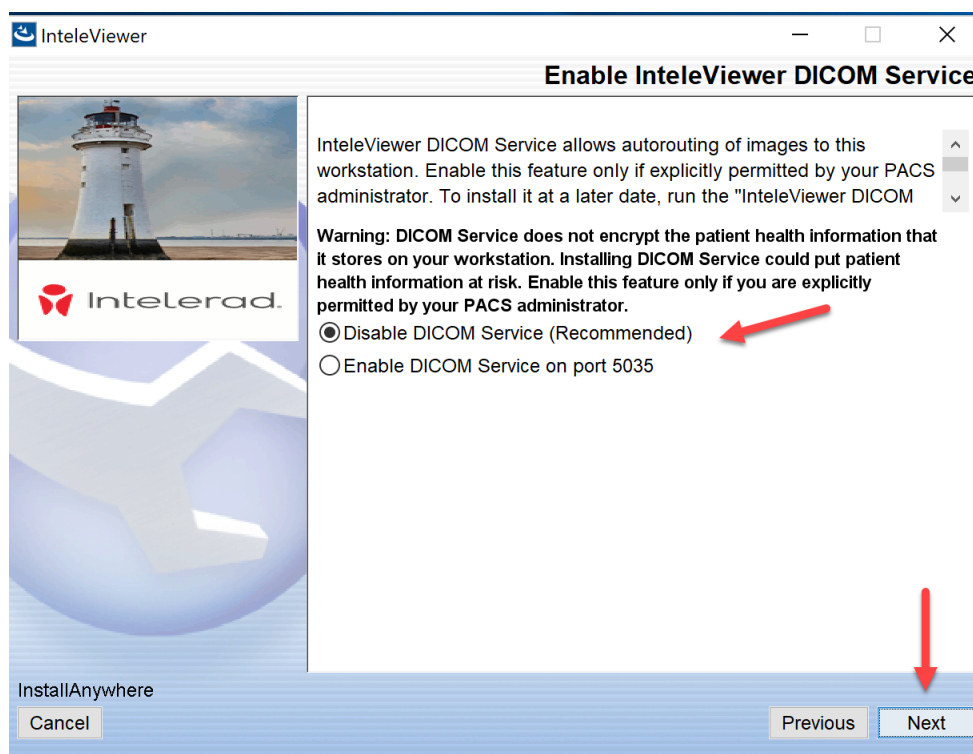

7. Select 'Done' to complete the installation. The Intelviewer Icon should not be viable in your desktop.

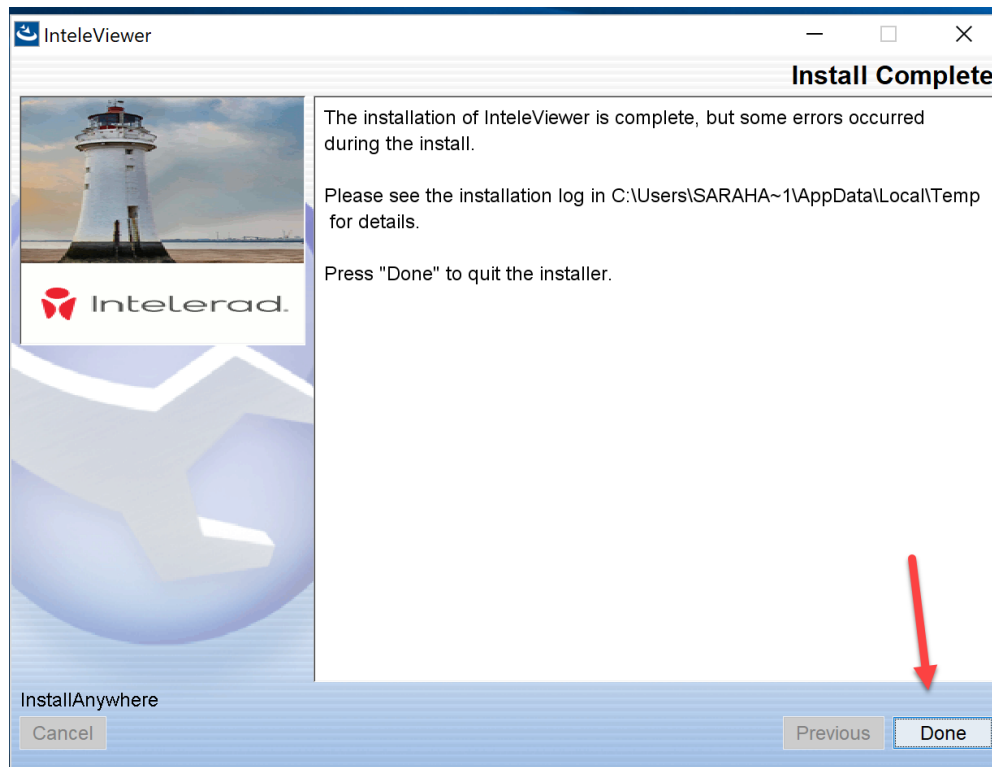

8. Follow the instructions on how to add the Spectrum Medical Imaging Bookmark to the Intelviewer application which can be found on our website at <https://www.spectrumradiology.com.au/inteleviewerinstallationtracks>